

Gerni

Classic 100.3
Classic 100.3 S
Classic 110.4
Classic 115.3
Classic 120.4



User Guide



Contents

| | | |
|-----------|---|-----------|
| 1 | Introduction | 4 |
| | 1.1 Symbols used to mark instruction..... | 4 |
| 2 | Safety precautions and working techniques | 4 |
| 3 | Before you start using your high pressure washer | 10 |
| | 3.1 Mounting of trolley handle and wheels | 10 |
| | 3.2 Mounting of quick coupling | 10 |
| 4 | Operating your high pressure washer | 11 |
| | 4.1 Connection of high pressure hose | 11 |
| | 4.2 Mounting of spray lance and Click&Clean nozzles | 11 |
| | 4.3 Water Connection | 11 |
| | 4.4 Starting the high pressure washer | 12 |
| 5 | After using the pressure washer | 12 |
| | 5.1 Stopping the high pressure washer | 12 |
| 6 | Maintenance | 13 |
| 7 | Troubleshooting | 13 |
| 8 | Warranty Conditions | 14 |
| 9 | Main technical Data | 15 |
| 10 | Declaration of Conformity | 16 |

1 Introduction

1.1 Symbols used to mark instruction

All pictograms attached to the high pressure washer and its components are shown and explained in this manual.



Safety instructions marked with this symbol must be observed to prevent personal injury or serious damage to property.



Caution where there is a risk of damaging the machine or its individual components.



This symbol indicates tips and instructions to simplify work and to ensure a safe operation of the high pressure washer.

2 Safety precautions and working techniques



Before starting up your machine for the first time, this instruction manual must be read through carefully. Save the instructions for later use.



WARNING!

- Inhalation of aerosols can be hazardous to health. Where applicable use a device in order to avoid or reduce aerosols production, e.g., a shield covering the nozzle. For protection against aerosols use a respiratory mask of class FFP 2 or higher.
- The high water pressure generated by the machine and the power connection are particular sources of danger.
- Machines shall not be used by children or untrained personnel. Children should be supervised to ensure that they do not play with the machine.
- Do not use the machine within range of persons unless they wear protective clothing.
- Before starting up your machine please check it carefully for any defects. If you find any, do not start up your machine, contact your Gerni distributor. The insulation of the electric cable should be faultless and without any cracks. If the electric cable is damaged, an authorized Gerni distributor should replace it.
- Always unplug the power plug before cleaning or maintenance and when replacing parts or converting the machine to another function.

- Observe the national safety regulations issued, for example, by the employers liability insurance association, social security institutions, occupational safety and health authorities or other organizations.



Accessories and spare parts

- To ensure the machine safety only use original spare parts from Gerni or approved by Gerni.
- High pressure hoses, fittings and couplings are important for the safety of the machine. Only use hoses, fittings and couplings recommended by Gerni.



Physical, sensory or mental conditions

- This machine is not intended for use by persons (including children) with reduced physical, sensory or mental capabilities or lack of experience and knowledge. If the machine is used by people with reduced physical, sensory or mental capabilities or lack of experience and knowledge they shall have been given supervision or instruction concerning use of the machine in a safe way and understand the hazards involved.



Applications

This machine has been developed for domestic use such as:

- Car, motorbike, boat, caravan, trailer, patio/drive/flagstones, woodwork, brickwork, barbecue, garden furniture, lawn mower.

Any other use is considered as improper use. Gerni accepts no liability for any damage resulting from such use. The risk for such use is borne solely by the user. Proper use also includes proper operation, servicing and repairs as specified in this instruction.

Clothing and equipment

Always take action to protect yourself when operating the machine.

- Wear shoes with non-slip soles.
- Wear goggles, ear protection and protective clothes

during operation.



Transporting the high pressure washer

- When transporting the machine in or on a vehicle, it must be secured, e.g. with straps, so that it cannot slip or tip over.
- Gerni recommends that the machine is positioned horizontally on the backside, when transported in or on a vehicle.



Detergents

- This machine has been designed for use with cleaning agents supplied or recommended by Gerni. The use of other cleaning agents or chemicals may adversely affect the function of the machine.



Before starting the work Inspecting the machine

- Do not use the machine if a supply cord or important parts of the machine are damaged, e.g., safety device, high pressure hose, and spray handle and spray attachments.
- The trigger of the spray handle must move easily and automatically return to its starting position when released.
- Always keep high pressure hose and spray attachment in good condition (clean, moving easily) and correctly assembled.

Electrical connection



WARNING!

Minimize the risk for electrical shock:

- Voltage and frequency of the machine (see rating plate) must match the voltage of and frequency of the mains supply.
- Only connect the machine to electrical installation made by a certified electrician and comply with IEC 60364-1.
- It is recommended that the electrical supply to the

machine should include a residual current device that will interrupt the supply if the leakage current to earth exceeds 30 mA for 30 ms.

- Inadequate extension cables can be dangerous. If an extension cable is used, it shall be suitable for outdoor use, and the connection has to be kept dry and off the ground.
- Gerni recommends use of an extension cable drum when cable extension is needed which keeps the socket at least 60 mm above the ground.
- If the electric cable is damaged, it must be replaced by an authorized Gerni distributor or similar qualified person in order to avoid a hazard.



Water connection

- This high pressure washer is only allowed to be connected with the drinking water mains, when an appropriate backflow preventer has been installed, Type BA according to EN 60335-2-79.
- The backflow preventer can be ordered under number 106411177.
- As soon as drinking water has flown through the backflow preventer, it is no longer regarded as drinking water.
- Operation by suction (e.g. a rainwater vessel) is carried out without a backflow preventer – see “**Connecting to a pressureless water supply**”. The machine can be connected to water mains with a max. inlet-pressure of 1 MPa/10 bars and max. 40°C.

Safety devices

Locking device on spray handle:

- The spray handle features a locking device. When the pawl is activated, the spray handle cannot be operated.

Thermal sensor:

- A thermal sensor protects the motor against overloading. The machine will restart after a few minutes when the thermal sensor has cooled.

Pressure safety device:

- An integrated hydraulic safety valve protects the system from excessive pressure.

During work



WARNING!

- It is not allowed to clean asbestos-containing surfaces with high pressure.
- Risk of explosion – Do not spray flammable liquids.
- Never draw in fluids containing solvents (e.g., gasoline, heating oil, paint thinner or acetone) These substances damage the materials used in the machine. Their spray is highly combustible, explosive and poisonous.
- Never direct the water jet at yourself, other persons, not even to clean clothing or footwear - **risk of injury**.
- Never direct the water jet at pets or other animals.
- Never direct the water jet at live electrical equipment or the machine itself - **danger of short-circuiting**.
- The spray lance is affected by a kickback force less than 20N and a sudden torque when activating the trigger of the spray handle during operation.
- This high pressure washer machine must not be operated at temperatures below 0°C.
- Never start up a frozen machine. Frost damages are not covered by the guarantee!
- Always ensure firm and safe footing.
- The machine shall be operated in an upright position.
- If the machine is left or not used for 5 minutes, it must be switched off on the start/stop switch "O" (1).

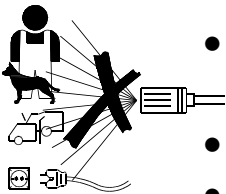

After finishing the work



WARNING!

- Always switch off the machine and unplug the power plug from the socket after work and when leaving the machine unattended.

- Disconnect water inlet hose between machine and water supply.
- Always empty pump, hose and accessories of water after use of the machine and prior to storing.

Maintenance and repairs



WARNING!

- Always disconnect the electrical plug from the socket prior to maintenance, cleaning and repair.
- Any repair should always be made in Gerni authorized workshop with original Gerni spare parts.
- Do not attempt any maintenance not described in the instructions.
- If the machine refuses to start, stops, pulsates, pressure fluctuates, motor busses, fuse blows or no water comes out, check the trouble shooting diagram in these instructions. In case other problems occur, please contact your local Gerni distributor.

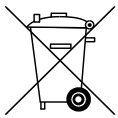

Recycling the high pressure washer

Make the old machine unusable immediately.

- Unplug the machine.
- Cut the electric cable.

Do not discard electrical appliances with household waste. As specified in WEEE Directive 2012/19/EC on old electrical and electronic appliances, used electrical goods must be collected separately and recycled ecologically. Contact your local authorities or your nearest dealer for further information.

3 Before you start using your high pressure washer



See the pictorial quick reference guide – unpacking.
Illustration shows the operation elements and how to prepare your machine for use.

Operation elements

1. Start/stop switch
2. Water inlet with filter (2a)
3. High pressure connection
4. High pressure hose
5. Electric cable
6. Click&Clean spray lance
7. Spray handle with lock (7a)
8. Click&Clean Tornado nozzle (Classic 100.3, Classic 110.4, Classic 115.3)
9. Click&Clean Tornado PR nozzle (C 120.4)
10. Click&Clean Powerspeed nozzle
11. Foam sprayer
12. Nozzle cleaning tool
13. Accessory storage
14. Model tag
15. Trolley handle
16. Holder for hose/electric cable (Classic 100.3 S, Classic 110.4, Classic 115.3, Classic 120.4)
17. Hexagon key for handle and bracket mounting
18. Wheel brackets
19. Wheels
20. Wheel caps

3.1 Mounting of trolley handle and wheels

Mounting of trolley handle

Only applicable for models with trolley handle (Classic 100.3 S, Classic 110.4, Classic 115.3, Classic 120.4)

- A1** Place the trolley handle (15) on the machine.
- A2** Secure the handle by mounting the 2 screws using the enclosed hexagon key (17).

Mounting of wheel brackets

Only applicable for models with wheels (Classic 110.4, Classic 115.3, Classic 120.4)

- A3** Place the wheel brackets (18) on the machine.
- A4** Secure the wheel brackets by mounting the 2 screws, using the enclosed hexagon key.
- A5** Place the wheels (19) on the wheel axle – push into position – you should hear a click when the wheels are in correct position.
- A6** Secure the wheels by mounting the wheel caps (20) – you should hear a click when the wheel caps are in correct position and the wheel is secured.

3.2 Mounting of quick coupling

- A7** When mounting the quick coupling for the first time, check that the factory fitted filter (2a) is positioned in the water inlet pipe.
- A8** Screw the quick coupling tight on to the water inlet (2).



IMPORTANT!

The inlet filter must always be fitted in the water inlet pipe to filter out sand, limestone and other impurities as these will damage the pump valves. The filter is factory fitted. Failure to fit the filter will invalidate the guarantee.

4 Operating your high pressure washer

B



See the pictorial quick reference guide – operating your high pressure washer.

4.1 Connection of high pressure hose

- B1** Attach the high pressure hose (4) to the spray handle (7). Detach the high pressure hose by pressing the button (A).
- B2** Mount the high pressure hose on the outlet (3).

4.2 Mounting of spray lance and Click&Clean nozzles

- B3** Push the spray lance (6) into the spray handle, twist and release.



NOTE!

The spray lance has a built-in low pressure nozzle that can be used for flushing away dirt.

- B4** When attaching the nozzles (8, 9, 10), press the nozzles into the spray lance.



IMPORTANT!

When attaching the click & Clean nozzles, the button on the side of the spray lance should come out again. The nozzle should stay in position when pulling it.

- B5** Push the foam sprayer (11) into the spray lance.



NOTE!

The foam sprayer features a swivel lock, which must be positioned in the hole in the Click & Clean spray lance. Press the button to detach the Click & clean nozzles and the foam sprayer.



IMPORTANT!

Before starting the cleaning job, check that the machine is in an upright position and placed on an even surface. Do not place the machine in long grass!

4.3 Water Connection



IMPORTANT!

Connecting to pressurized water supply

The inlet water max. pressure is 1 MPa/10 bar and the max. temperature is 40°C – see rating plate. An ordinary ½" garden hose of min. 10 m and max. 25 m will be suitable.

- B6** Check that the filter is fitted in the water inlet pipe and that it is not clogged up.
- B7** Connect the water hose to the water supply by means of the quick connector. Turn on the water.

Connection to the drinking water mains according to national and local regulations.



Let the water run through the water hose before connecting it to the machine to prevent sand and dirt from penetrating the machine.

- B8** Turn off the water and connect the water hose by means of the quick coupling to the water inlet.



Connecting to pressure less water supply

The machine can also operate in suction mode, meaning that you can connect the machine to e.g. rainwater vessels, rivers, lakes and cisterns etc.

When connecting the machine to operate from pressure less water supplies – always use ad-



ditional filtering to secure that impurities are not sucked in. Hose length should be max. 3 meter and of minimum ½".

To meet these requirements, Gerni recommends that you use the original Gerni suction hose kit.

The Machine is designed for suction up to 50 cm above the water surface.

- Position the machine at max. 0.5 meter above water surface. Detach the high pressure hose from the outlet.
- Ensure that the inlet filter is in position and attach the suction hose kit, secure tight connection to the inlet.
- Turn on the machine, pressing the start/stop switch (1) into position "I".
- Wait until a steady jet exits the outlet.
- Switch off the machine and attach high pressure hose (4), spray handle, lance and nozzle.
- Start the machine again and activate the spray handle.

4.4 Starting the high pressure washer



IMPORTANT!

Connecting to mains power supply

The voltage and frequency of the machine (see model tag (14)) must match the voltage and frequency of the power supply.

B9 Insert the power plug into power supply socket.

B10 Turn on the water.

B11 Release the trigger lock (7a). Remember to unplug, turn off the high pressure washer and lock the trigger, when leaving the high pressure washer unattended

B12 Activate the trigger of the spray handle and let the water run until all air has escaped from the water hose.

B13 Turn on the machine, pressing the start/stop switch into position "I".

B14 Activate the trigger of the spray handle. When releasing the trigger of the spray handle, the machine automatically stops. The machine will start again when you reactivate the trigger of the spray handle.



5 After using the pressure washer

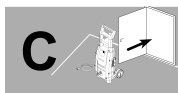

See the pictorial quick reference guide – storing the high pressure washer.



The high pressure washer should be stored in a frost free room! Should the machine by a mistake be frozen, it will be necessary to check it for damages.

5.1 Stopping the high pressure washer

C1 Shut off the water supply and activate the trigger of the spray handle and let the machine run until no more water runs out of the nozzle. This will wash out water hose, high pressure hose, spray lance and nozzles.

C2 Stop the machine, pressing the start/stop switch into position "0".

C3 Unplug the machine from the power supply socket and wind up the electrical cable (5) and place it on the holder (16).

C4 Rinse the spray lance, nozzles and the foam sprayer after use.

C5 Place spray handle, lance, nozzles, foam sprayer and other accessories in the holders on the high pressure washer.

6 Maintenance

D



See the pictorial quick reference guide - maintenance.



To ensure a long and problem free working life of the high pressure washer, please take the following advices:

- Wash out water hose, high pressure hose, spray lance and accessory before mounting
- Clean the connectors of dust and sand
- Rinse the detergent bottle and the detergent nozzle
- Clean the nozzle
- Keep the water inlet filter clean and unclogged

Cleaning of the water inlet filter

D1 Clean the water inlet filter regularly once a month or more frequently according to use. Carefully loosen the filter with a screwdriver and clean it. Check that it is intact before remounting it.

Cleaning of nozzle

A clogging up in the nozzle causes a pump pressure which is too high, why cleaning is required immediately.



IMPORTANT!

The nozzle cleaning tool (12) should only be used when the nozzle is detached and the machine is stopped!

- D2** Stop the machine and disconnect the nozzle. Clean the nozzle.
- D3** Flush the nozzle backwards with water.

Cleaning of machine vents

D4 The machine should be kept clean so as to let cooling air pass freely through the machine vents.

Greasing of O-rings

D5 To ensure an easy connection and that O-rings do not dry up the couplings should be greased regularly.

7 Troubleshooting

To avoid unnecessary disappointments, you should check the following before contacting the Gerni service organization.

| Symptom | Cause | Recommended action |
|---------------------------------|---|---|
| Machine refuses to start | Machine not plugged in Defective socket Fuse has blown Defective extension cable | Plug in machine Try another socket. Replace fuse. Switch off other machines. Try without the extension cable. |
| Fluctuating pressure | Pump sucking air Valves dirty, worn out or stuck Pump seals worn out | Check that hoses and connections are air-tight. Contact your local Gerni Service centre. Clean and replace or refer to local Gerni distributor. |

| Symptom | Cause | Recommended action |
|---|---|--|
| Machine stops | Fuse has blown Incorrect mains voltage Thermal sensor activated Nozzle partially blocked | Replace fuse. Switch off other machines. Check that the mains voltage corresponds to specification on the model tag. Leave the washer for 5 minutes to cool down. Clean the nozzle (see section 6.2) |
| Fuse blows | Fuse too small | Change to an installation higher than the amp. consumption of the machine. You may try without the extension cable. |
| Machine pulsating | Air in inlet hose/pump Inadequate supply of mains water Nozzle partially blocked Water filter blocked Hose kinked | Allow machine to run with open trigger until regular working pressure resumes. Check that the water supply corresponds to specifications required (see model tag) NB! Avoid using long, thin hoses (min. 1/2") Clean the nozzle (see section 6.2) Clean the filter (see section 6.1) Straighten out hose. |
| Machine often starts and stops by itself | Pump/spray handle is leaking | Contact your nearest Gerni Service Centre. |
| Machine starts, but no water comes out | Pump/hoses or accessory frozen No water supply Water filter blocked Nozzle blocked | Wait for pump/hoses or accessory to thaw. Connect inlet water. Clean the filter (see section 6.1) Clean the nozzle (see section 6.2) |

In case problems other than the above occur, please phone 1300 733 171 or check our website www.gerni.com.au for your nearest service agent.

8 Warranty Conditions

Our goods come with guarantees that cannot be excluded under the Australian Consumer Law. You are entitled to a replacement or refund for a major failure and for compensation for any other reasonably foreseeable loss or damage. You are also entitled to have the goods repaired or replaced if the goods fail to be of acceptable quality and the failure does not amount to a major failure.

Gerni high-pressure washers for domestic use are warranted for 2 years from the date of purchase by:

AUSTRALIA:

Nilfisk Pty Ltd
Unit 1/13 Bessemer Street
Blacktown NSW 2148
Phone: 1300 556 710
E-mail: Warranty.au@nilfisk.com

NEW ZEALAND:

Accent Tools Ltd
232 Bush Rd
Albany
Auckland 0632
Phone: 09 968 2610
E-mail: sales@accent-tools.co.nz

Equipment defects covered by this warranty will be repaired or replaced by one of the service centres of the Gerni organisation. Find your local service agent here:

<http://www.gerni.com.au/>.

If your high pressure washer or accessories are handed in for repair, it must be followed by a description/specification of the fault, and the original purchase receipt, or a copy, must be enclosed.

Packing and postage/carriage is not covered by the warranty.

The benefits under this warranty are in addition to your national law of sale.

Guarantee repairs are made on the following conditions:

- that defects are attributable to flaws or defects in materials or workmanship. (wear and tear as well as misuse are not covered by the guarantee).
- that the directions of this instruction manual have been thoroughly observed.
- that repair has not been carried out or attempted by other than Gerni-trained service staff.
- that only original accessories have been applied.
- that the product has not been exposed to abuse such as knocks, bumps or frost.
- that only water without any impurities has been used.
- that the high pressure washer has not been used for rental nor used commercially in any other way.

Repairs not covered by the guarantee conditions will be invoiced. (i.e. malfunctions due to **Causes** mentioned in section **Trouble Shooting** of the instruction manual).

Please phone 1300 733 171 (Australia) or 09 9682610 (NZ) for service or warranty assistance only after checking possible causes in the trouble shooting chart on page 13.

9 Main technical Data

| Type | | Classic 100.3 | Classic 110.4 | Classic 115.3 | Classic 120.4 |
|--|----------------------|------------------|------------------|------------------|------------------|
| Electric specifications | | | | | |
| Rated voltage | V | 220-240 | 220-240 | 220-240 | 220-240 |
| Rated frequency | Hz | 50/60 | 50/60 | 50/60 | 50/60 |
| Rated power consumption | kW | 1.3 | 1.4 | 1.4 | 1.4 |
| Current | A | 5.7 | 6.1 | 6.1 | 6.1 |
| Protection class | Class I/ Class II | Class II | Class II | Class II | Class II |
| Protection degree | IP xx | IPX5 | IPX5 | IPX5 | IPX5 |
| Hydraulic specifications | | | | | |
| Rated pressure | MPa/bar | 7/70 | 7.5/75 | 8/80 | 8.5/85 |
| Max. pressure | MPa/bar | 10/100 | 11/110 | 11.5/115 | 12/120 |
| Rated water flow | l/min/l/h | 5.3/320 | 5.2/310 | 5.2/310 | 5.2/310 |
| Max. water flow | l/min/l/h | 7.3/440 | 7.3/440 | 7.3/440 | 7.3/440 |
| Max. water inlet pressure | Mpa/bar | 1/10 | 1/10 | 1/10 | 1/10 |
| Max. water inlet temperature | °C | 40 | 40 | 40 | 40 |
| Max. water inlet temp. suction mode | °C | 20 | 20 | 20 | 20 |
| Weight | | | | | |
| Weight | kg | 5.1 (6.1)* | 5.5 | 6.1 | 6.7 |
| Hand-arm vibration according to ISO 5349-1: Standard nozzle | | | | | |
| Hand-arm vibration according to ISO 5349-1: Standard nozzle | m/s ² | < 2.5 ±1 | < 2.5 ±1 | < 2.5 ±1 | < 2.5 ±1 |
| Sound pressure level L_pA in accordance with ISO 3744 | | | | | |
| Sound pressure level L _p A in accordance with ISO 3744 | dB(A) | 74 ±3 | 74 ±3 | 74 ±3 | 74 ±3 |
| Guaranteed sound power level LWA in accordance with 2000/14/EC | | | | | |
| Guaranteed sound power level LWA in accordance with 2000/14/EC | dB(A) | 90 | 90 | 90 | 90 |

We reserve the right to make alterations.

* C 100.3 S

10 Declaration of Conformity

We,

Niifisk A/S
Kornmarksvej 1
DK-2605 Broendby
DENMARK

Hereby solely declare, that the product:

| Product | Description | Type |
|----------------|----------------------------------|--|
| HPW - Consumer | 220 - 240 V 1~, 50/60 Hz - IP X5 | Gerri Classic 100.3 / Classic 100.3 S, Classic 110.4, Classic 115.3 / Classic 120.4 and accessory variants of above-mentioned types |

Is in compliance with the following standards:

| Id and Version | Title |
|-------------------------------------|--|
| EN 60335-1:2012+A11:2014 | Household and similar electrical appliances - Safety - Part 1 : General requirements |
| EN 60335-2-79:2012 | Household and similar electrical appliances - Safety - Part 2-79: Particular requirements for high pressure cleaners and steam cleaners |
| EN 55014-1:2006+A1:2009 +A2:2011 | EMC - Requirements for household appliances, electric tools and similar apparatus - Part 1: Emission |
| EN 55014-2:1997+A1:2001 +A2:2008 | EMC - Requirements for household appliances, electric tools and similar apparatus - Part 2: Immunity - Product family standard |
| EN 61000-3-11:2000 | Electromagnetic compatibility (EMC) - Part 3-11: Limits - Limitation of voltage changes, voltage fluctuations and flicker in public low-voltage supply systems, for equipment with rated current ≤ 75 A per phase and subject to conditional connection |
| EN 50581:2012 | Technical documentation for the assessment of electrical and electronic products with respect to restriction of hazardous substances |

Following the provisions of:

Machinery Directive 2006/42/EC
EMC Directive 2004/108/EC → April 20, 2016 → 2014/30/EC
RoHS Directive 2011/65/EC

Noise Emission Directive 2000/14/EC – Conformity assessment procedure according to Annex V.

Compliance to harmonic current emissions is documented in the TCF

Measured noise level: 74 dB; Guaranteed noise level: 90 dB

Hadsund 2015-12-02 Anton Sørensen
Senior Vice President – Global Operations
R&D – Vacuum Cleaners and High Pressure Washers



| | | | |
|-------|------|-------------|-----------|
| Place | Date | Name, Title | Signature |
|-------|------|-------------|-----------|

A

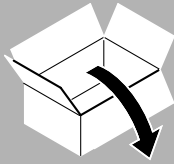

Classic 115.3

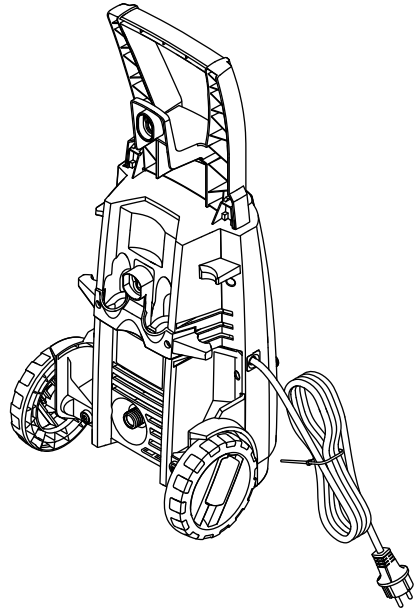
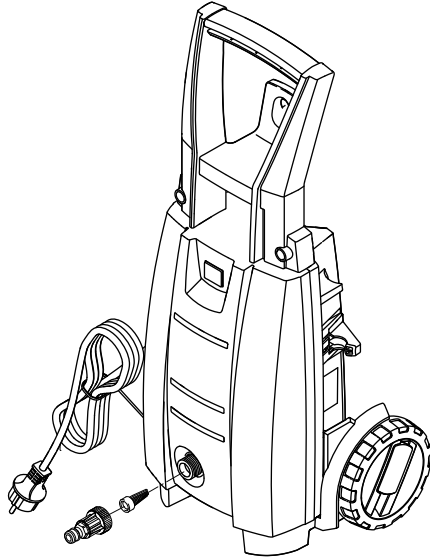

Classic 120.4

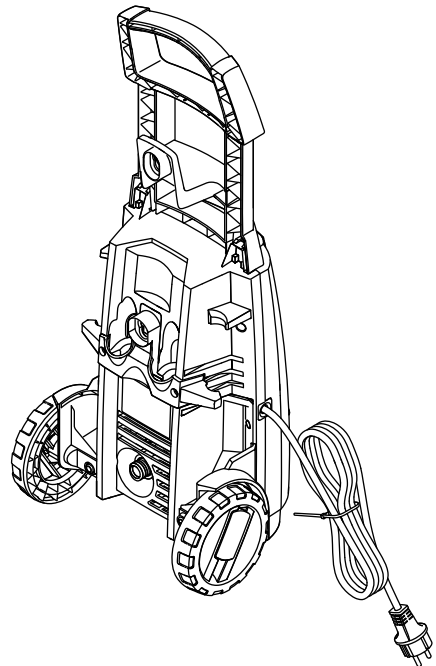
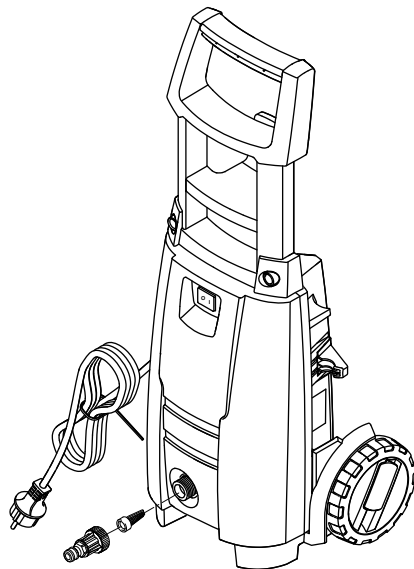

A

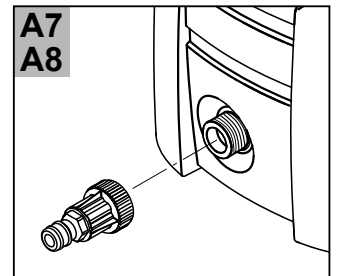
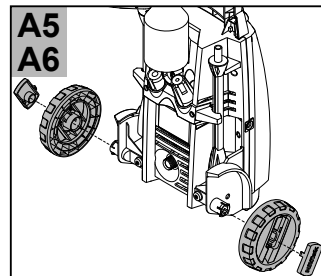
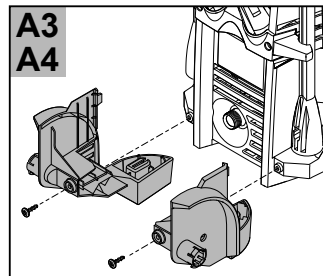
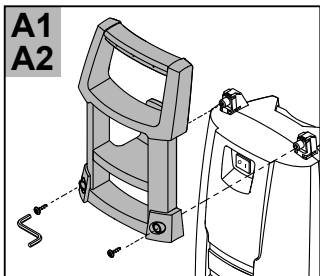
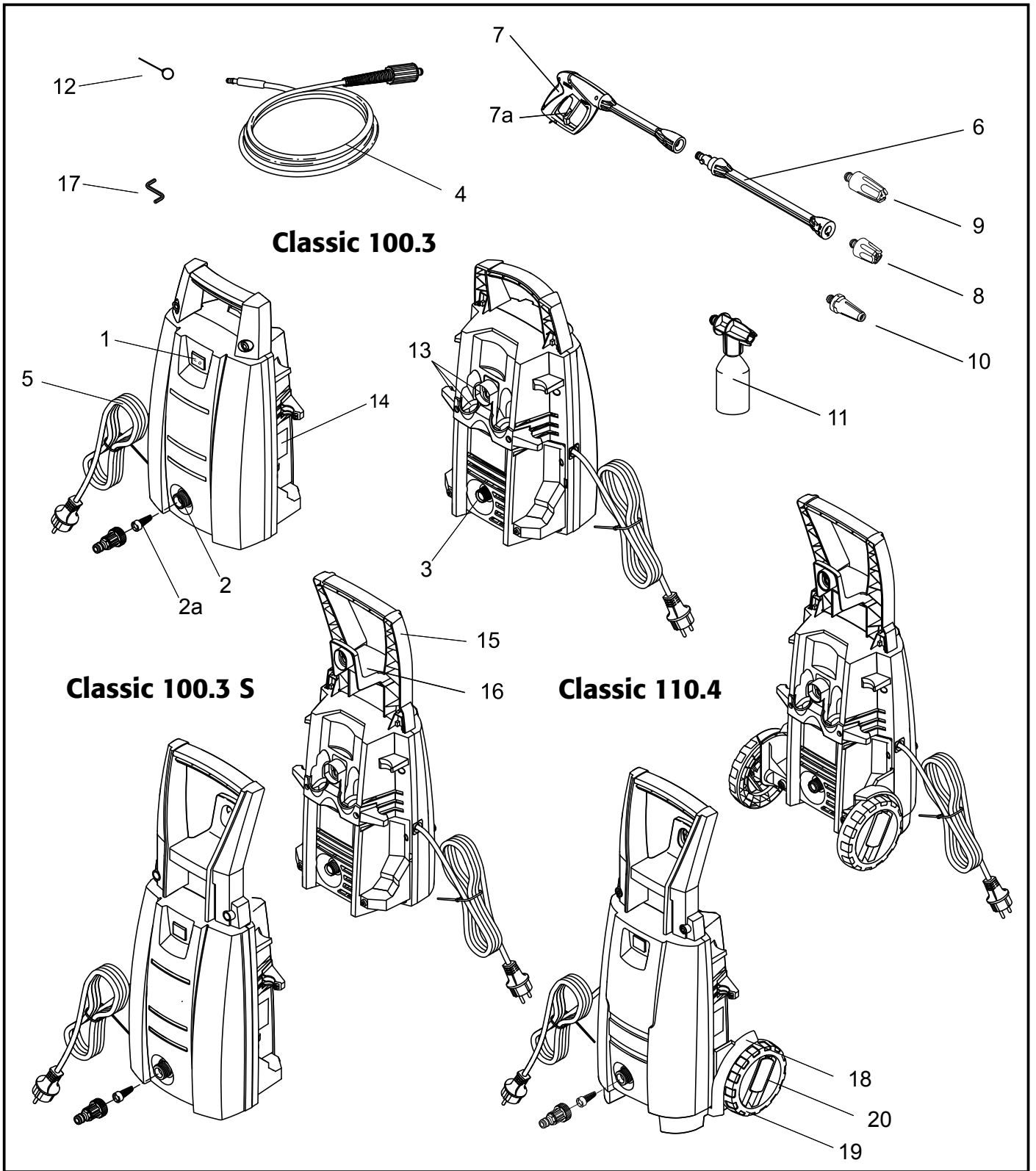
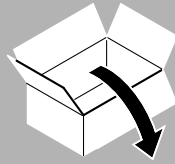

B

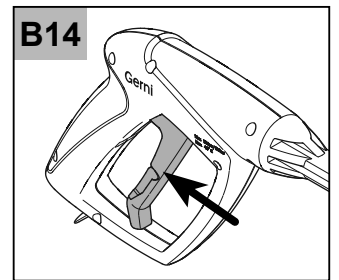
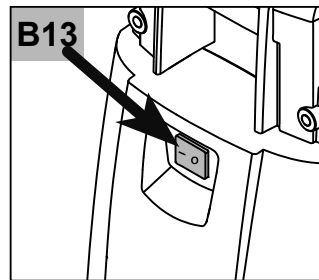
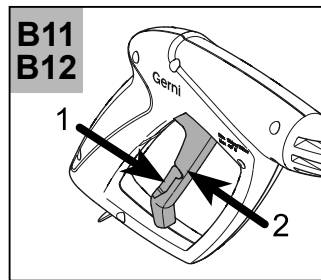
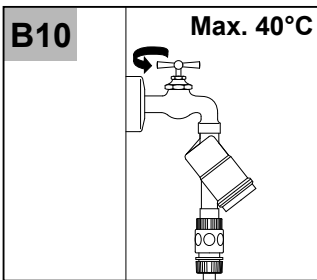
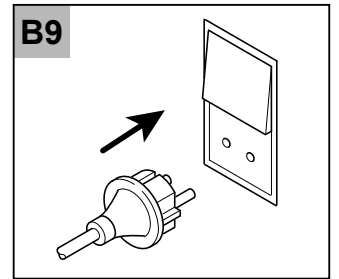
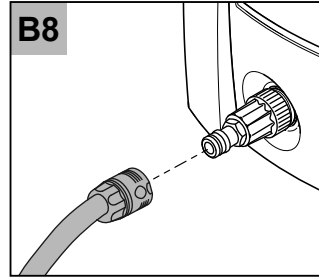
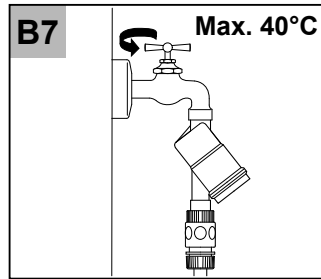
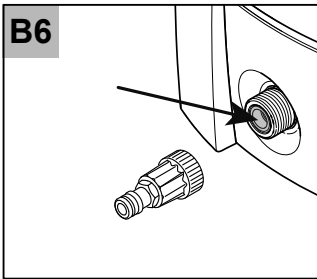
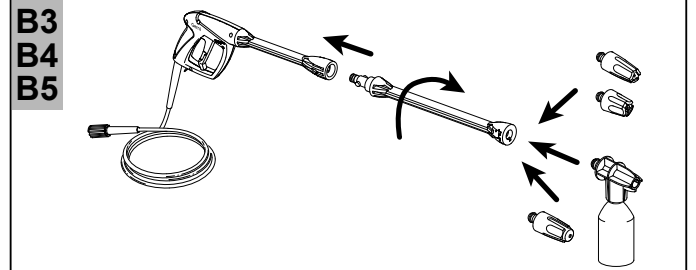
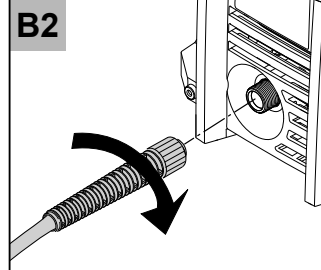
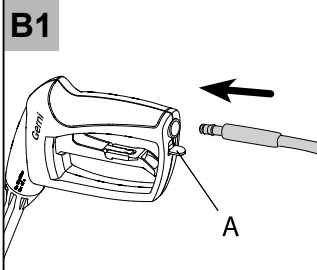

C

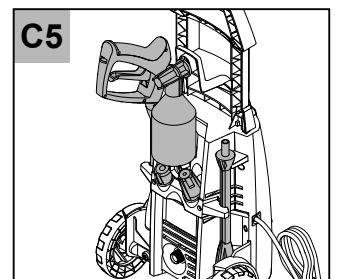
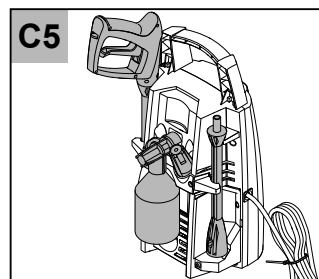
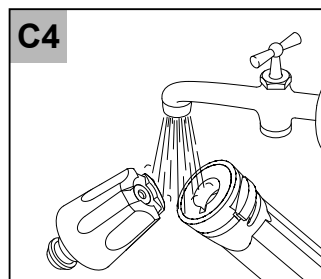
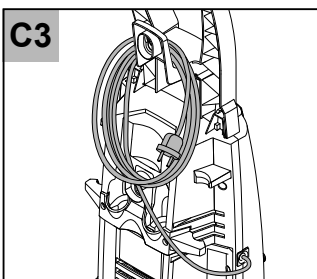
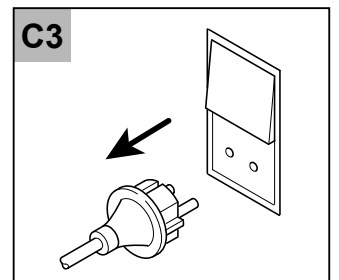
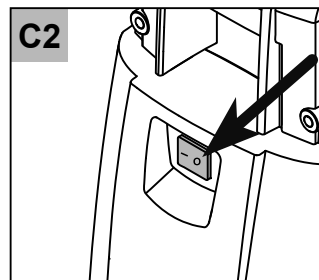
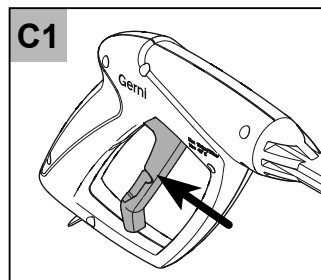
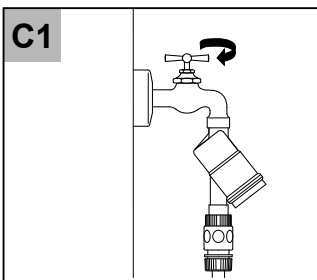
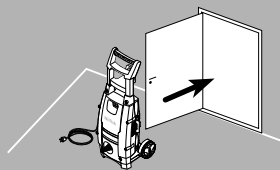

D

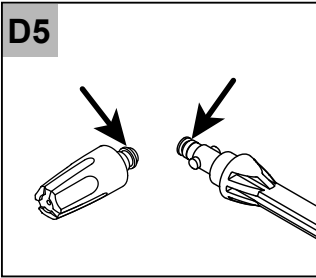
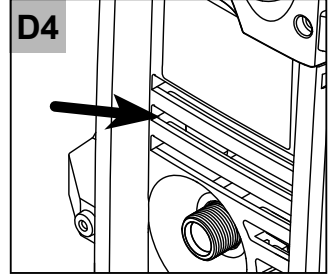
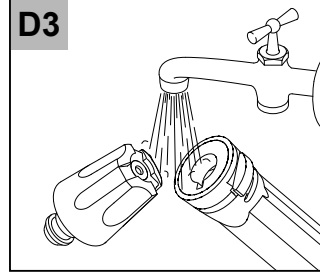
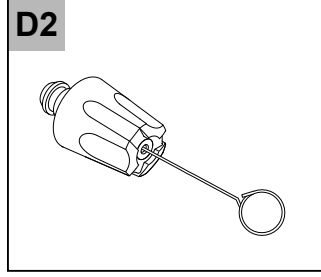
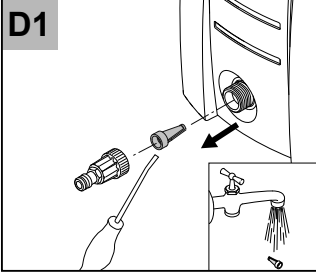

AUSTRALIA:

Nilfisk Pty Ltd
Unit 1/13 Bessemer Street
Blacktown NSW 2148

Phone: 1300 556 710
E-mail: info.au@nilfisk.com

NEW ZEALAND:

Accent Tools Ltd
232 Bush Rd
Albany
Auckland 0632

Phone: 09 968 2610
E-mail: sales@accent-tools.co.nz